



City of Carlisle
PO Box 430
100 N. 1st St
Carlisle, IA 50047

Ph: (515) 989-3224
Fax: (515) 989-4395

FENCE PERMIT APPLICATION

Date Submitted: _____

Name of Applicant: _____

Applicant Phone Number: _____

Job Address: _____

Fence Material: _____ Height: _____ feet

You must include a site plan showing the location of the fence to adjacent property lines, buildings, and street. Additionally, include the location and width of gates. All items are required for the application to be considered complete. Incomplete applications will not be moved to review until complete.

SIGNATURE OF APPLICANT

DATE

***BEFORE YOU DIG IN IOWA CALL 811
FOR MARKING UNDERGROUND UTILITY LINES***



DO NOT WRITE IN SPACE BELOW - FOR OFFICE USE ONLY

Electric Superintendent Approval

Date Approved

Gate Required (yes or no)

Water Superintendent Approval

Date Approved

Gate Required (yes or no)

City Administrator Approval

Date Approved

Number of Buildings Now on Lot_____ Use of Buildings Now on Lot_____

Proposed Use for New Improvement_____

TYPICAL RESIDENTIAL PROPERTY LAYOUT

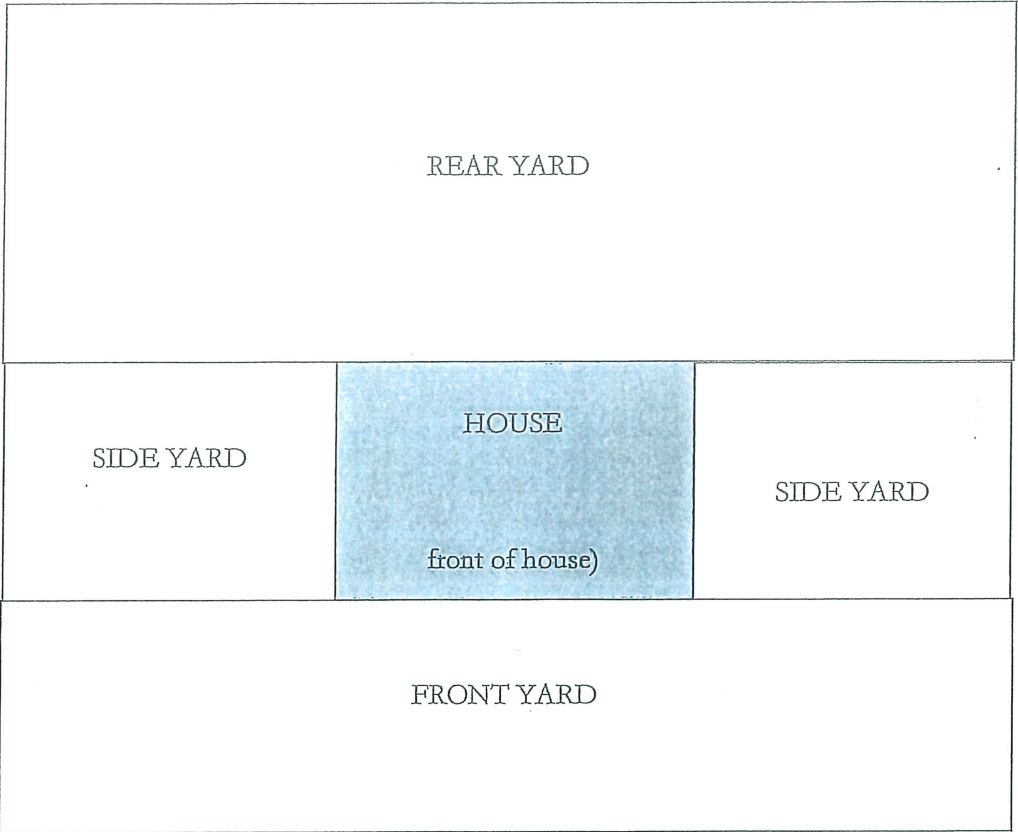

Property Line

166.09 FENCES, WALLS AND VISION CLEARANCE.

1. On a corner lot, nothing shall be erected, placed, planted, or allowed to grow in such a manner as to impede vision between a height of two and one-half feet and ten feet above the centerline grades of the area described as follows: that area bounded by the street right-of-way lines of a corner lot and a straight line joining points on said right-of-way lines 25 feet from the point of intersection of said right-of-way lines. This regulation does not apply to the C-2 District.
2. In any district, fences and walls not exceeding six feet in height are permitted within the limits of side and rear yards. A fence or wall not exceeding four feet in height is permitted within the limits of front yards. In the case of retaining wall supporting embankments, the above requirements shall apply only to that part of the wall above the ground surface of the retained embankment.
 - A. In any district where a fence or wall is required by a section of the Zoning Regulations, the Subdivision Regulations or other regulations of the Code of Ordinances, to serve as a screening wall, buffer wall, or other separating or protective wall, the restrictions of subsection 1 above shall be subject to the requirements of the said specific regulations.
 - B. Grade for determining the maximum height above grade for fences and walls:
 - (1) For a fence or wall along a street right-of-way, grade shall be the highest point of the pavement lying between the intersection of the centerline and a projection of the side lot lines.
 - (2) For a fence or wall between the front lot line and the front building line, grade shall be prorated between the grade at the front lot line and the grades at the building.
 - (3) For a fence or wall along the rear lot line or between the front building line and rear lot line, grade shall be the grade at the building, or natural grade at the fence line, whichever is the higher.
 - C. Fences and walls on a corner lot shall comply with the vision clearance requirements of subsection 1 above.
3. Fences shall be built wholly on the owner's property unless it is otherwise agreed to by the owner of the adjacent property.
4. All newly constructed fences may be required to provide immediate access for utility servicing, by means of a seven-foot gate or an easily removable section of fence. The determination will be made by the City after doing a site investigation of existing easements. In addition, any new fence construction will not be permitted within three feet of a transformer door without installing a three-foot access gate.
5. Fences located in R-1a, R-1, R-2, R-3, C-1, C-1a, C-2, C-3 and C-4 Districts must be constructed of materials commonly used in fence construction. Woven wire, electric, sheet metal, barbed wire, cloth, plastic sheeting, snow fencing, temporary or emergency fence material or salvage material will not be permitted for new fences. Any material other than commonly used fencing lumber, stone, or chain link must be approved. Hedges can be used as barriers or for landscaping purposes, provided no traffic hazards are created and no street signs are obscured from any direction of travel on any City street, intersection, driveway, sidewalk, or alley. Hedges and bushes shall not be planted any closer than three feet to any property line or easement line without approval.

ORDINANCE NO. 671

ORDINANCE AMENDING THE CODE OF ORDINANCES OF THE
CITY OF CARLISLE, IOWA BY AMENDING PROVISIONS
PERTAINING TO FRONT YARD FENCES.

BE IT ENACTED by the City Council of the City of Carlisle, Iowa:

SECTION 1 - Chapter 166, Section 09(2) of the Code of Ordinances of the City of Carlisle, Iowa is repealed and the following adopted in lieu thereof:

166.09(2) In any district, fences and walls not exceeding six feet in height are permitted within the limits of side and rear yards. Only a picket-style or ornamental fence, not exceeding four feet (4') in height, is permitted within the limits of front yards. In the case of retaining wall supporting embankments, the above requirements shall apply only to that part of the wall above the ground surface of the retained embankment.

SECTION 2.. Repealer. All Ordinances or parts of Ordinances in conflict with the provisions of this Ordinance are hereby repealed.

SECTION 3. Severability Clause. If any section, provision or part of this ordinance shall be adjudged invalid or unconstitutional, such adjudication shall not affect the validity of the ordinance as a whole or any section, provision or part thereof not adjudicated invalid or unconstitutional.

SECTION 4. When Effective. This ordinance shall be in effect from, and after, its final passage, approval and publication as provided by law.

PASSED by the Council the 10th day of November, 2014, and approved by the Council this 10th day of November, 2014.

Ruth Randleman
MAYOR

ATTEST:

Andrew Lent
CITY ADMINISTRATOR/CLERK

First Reading: November 10, 2014
Second Reading: Waived
Third Reading: Waived
Published: November 26, 2014